

Site # 16

N

18

74

M Lafayette St

S Washington St

Earl Scruggs Center

E Warren St

© 2013 Google

Google earth

78 ft

1993

Imagery Date: 4/2/2011 35°17'28.05" N 81°32'21.91" W elev 894 ft eye alt 1266 ft



Site # 17



I-85S Welcome Center Kings Mtn Exhibit Sign



© 2013 Google



1994

Imagery Date: 3/5/2012 35°10'59.04" N 81°24'26.76" W elev 910 ft eye alt 1306 ft

Google earth  
NC Welcome Center Rd



# Site # 18



# Site # 19

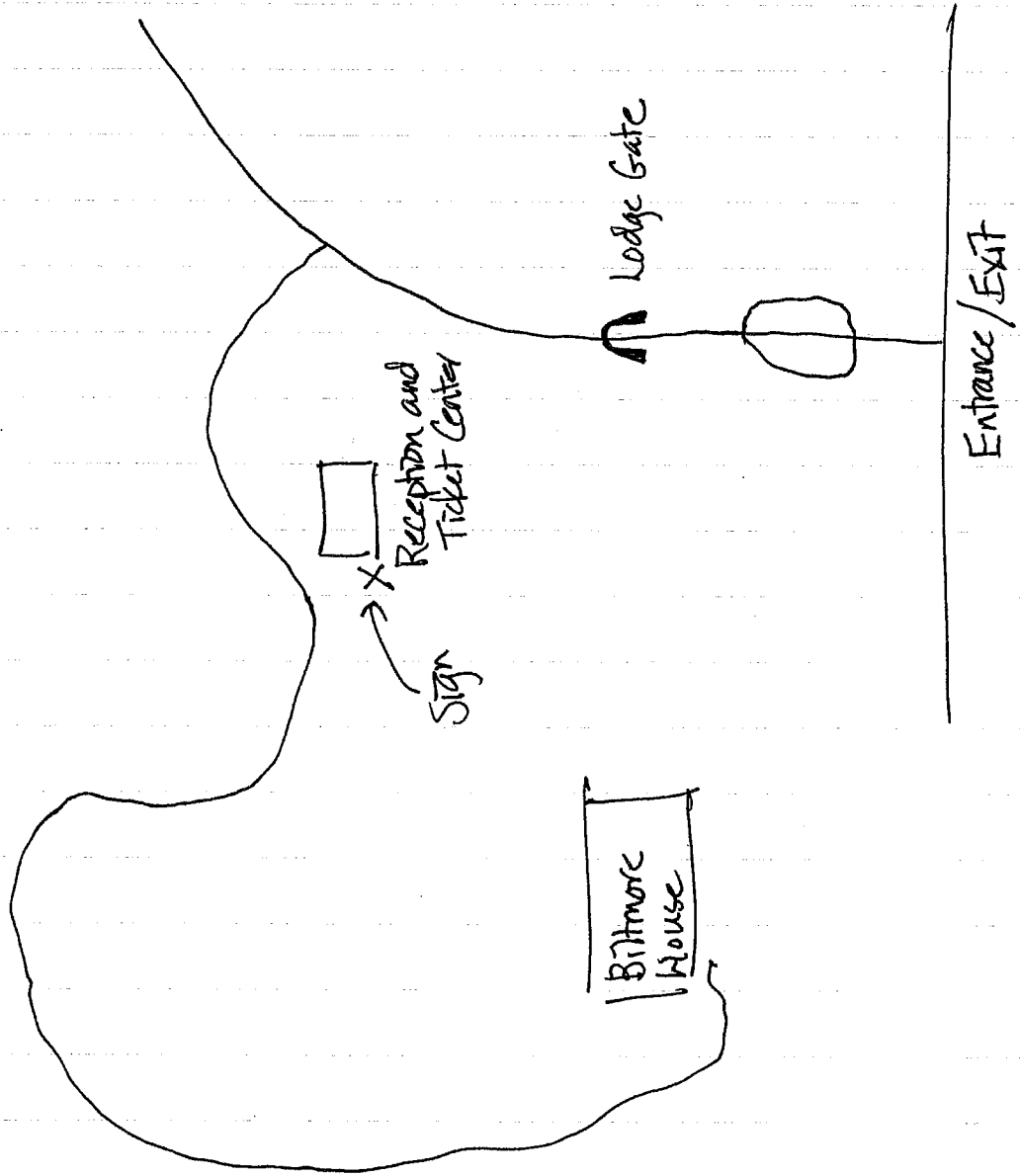

# Site # 20

sponsored by  
Business to Business,  
Entrepreneurs Association.  
Learn more on the web!  
mountain.com

**L-3 Tanner Retail Store**  
119 Broadway St. 828-669-1117  
Tanner ladies five apparel and accessories  
in sizes two through twenty four

**J-2 Town & Country Furniture Market**  
106 Sutton Ave. 828-669-0075  
Brand name furniture. Discount prices.  
Nationwide delivery. Studio flower Gallery.

**I-1 Town Hardware & General Store**  
103 W. State St. 828-669-7731  
Old fashioned toys & housewares, woodworking tools, gardening gifts, books  
& much more!

**L-4 Tyson Furniture Company**  
109 Broadway 828-669-3000  
Area's largest furniture store (70,000 sq. ft. showroom).  
Over 300 brands, discount prices, nationwide delivery.

**M-4 Greybeard Realty**  
304 East St. Street, 828-669-1072  
Over 150 vacation and long-term rentals. Specializing in local real estate sales.

**I-12 Mountain Vista Properties**  
118 Broadway 828-669-1500 or 800-354-0954  
mviewstaprop@aol.com. Specializing in Black Mountain and greater Asheville  
real estate. Offering full services, Multiple Listing, buyer referral, market  
analysis and more.

## Cafes, Restaurants, Food, Sweets

**L-2 Berliner Kindi German Restaurant & Deli**  
103 Broadway 828-669-2455  
Authentic German cuisine served in a true Bavarian style atmosphere.  
Lunch & Dinner @ 11AM to 8PM

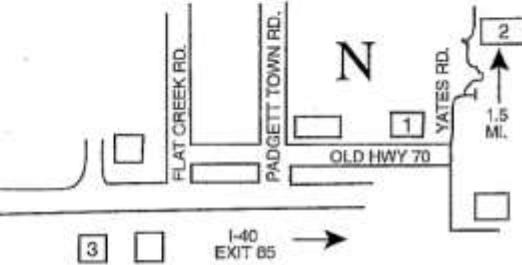
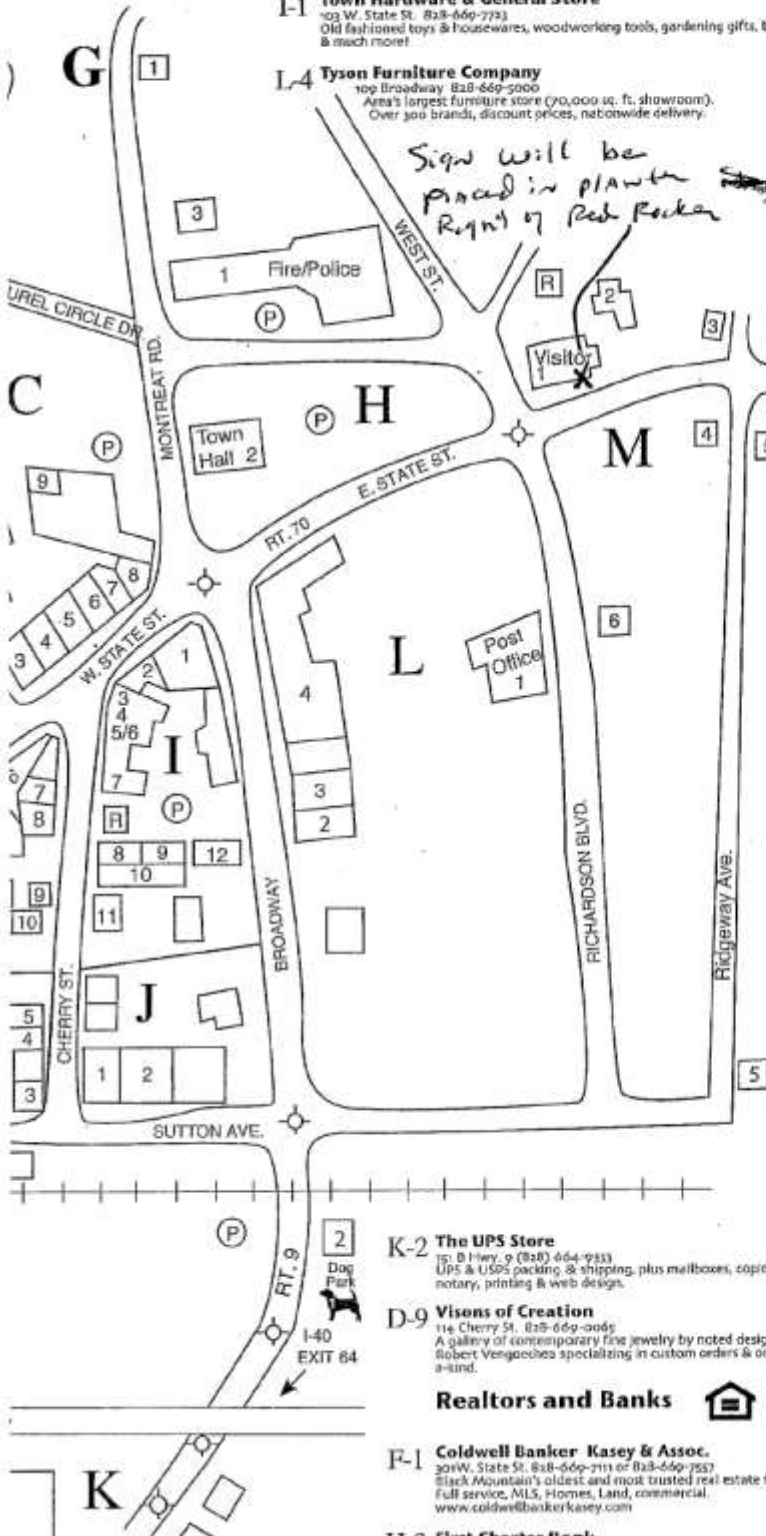

**C-2 Black Mountain Bakery**  
102 Church St. 828-669-6545  
Chef-owned bakery serving breakfast, lunch, pastries, breads,  
desserts & cakes. Dine-in or cafe seating under the trees.

**M-2 Black Mountain Bistro**  
203 East State St. 828-669-5041  
Join us for a taste of home. Seafood, steaks, ribs, salads & more  
made fresh daily. Kids menu, outdoor seating. Closed Sunday.

**L-5 Black Mountain Farmer's Market**  
151 S. Ridgeway Ave. 828-669-0060  
Local year-round organic produce, heirloom plants & herbs,  
eggs, honey, jams, baked goods, chocolates, coffee. Lots more!

**F-2 Black Mountain Natural Foods**  
108 Black Mountain Ave. 828-669-9813 M-Sat 10-6  
Expanded selection of vitamins, herbs and natural food, including  
gluten-free & dairy-free items. Bulk food & spices. Behind Suntrust Bank.

**F-5 Camino's Western Carolina Border Cafe'**  
197 Black Mountain Ave. 828-669-1982  
Southwestern grill & games open for lunch & dinner in season.

**I-9 The Cellar Door Restaurant**  
117-C Cherry St., 828-669-9090  
Our menu features an array of local indigenous cuisine with an  
upscale twist. Open Mon-Sun 11-9:30

**C-7 Chocolate Gems**  
100 W. State Street 828-669-9105  
Handmade truffles & bark. Unique chocolate gifts & boxes.  
www.chocgems.com

**A-3 Coach House Seafood & Steak**  
108 West State St. 828-669-4223  
Enjoy the best fried and broiled seafood in WNC. Also, serving steaks &  
chicken. All served in a country home atmosphere.

**D-3 The Dripolator Coffeehouse**  
221 W. State St. 828-669-0099  
Open early/late 7 days. Voted Best in WNC! Fair trade coffee, espresso,  
pastries. Free wireless internet!

**M-5 Front Porch Grill**  
306 East State St. 828-664-0069  
Restaurant open 6 AM - close 9 PM. Home of the Old-fashioned  
hamburger and more.

**D-4 Green Light Cafe**  
305 West State St., 828-669-2444  
Black Mountain's only vegetarian restaurant. A full menu featuring locally  
grown produce. All items made from scratch.  
Serving lunch, dinner & Sun. Brunch.

**D-8 My Father's Pizza**  
110 Cherry St. 828-669-4944 - Open 11-9 M-Th; 11-11 F-Sat; 12-8 Sun.  
Gourmet Pizza, Pasta & more. Family dining, take-out, patio-seating.

**E-5 Pepper's Deli**  
111 Cherry St. 828-669-1825  
Tasty sandwiches, soups & salads. Serving Black Mtn. since 1983. Unique  
collection of Dr. Pepper memorabilia. Indoor/Outdoor dining & take-out.  
Mon-Sat 11-3. Daily specials. Book private parties after hours.

**F-4 Power House Perks**  
111 Black Mountain Ave. 828-669-9300  
100% all natural smoothies, superior espresso, chat, inspirational books,  
music and free WiFi.

**I-10 Veranda Cafe & Gifts**  
119 Cherry St. 828-669-8864  
Enjoy gourmet sandwiches, salads, homemade soups and desserts.  
Dine inside or out on our deck. Open 8 days Mon-Sat, 11-3

**K-2 The UPS Store**  
151 D Hwy. 9 (828) 664-9333  
UPS & USPS packing & shipping, plus mailboxes, copies,  
notary, printing & web design.

**D-9 Visions of Creation**  
114 Cherry St. 828-669-0069  
A gallery of contemporary fine jewelry by noted designer  
Robert Vengaschesa specializing in custom orders & one-of-  
a-kind.

## Realtors and Banks

**F-1 Coldwell Banker Kasey & Assoc.**  
301 W. State St. 828-669-2111 or 828-669-7557  
Black Mountain's oldest and most trusted real estate firm.  
Full service, MLS, Homes, Land, commercial.  
www.coldwellbankerkasey.com



Site # 21

74A

Shindig on the Green

© 2013 Google

Google earth

38 ft

1994

Imagery Date: 10/20/2010 35°35'44.49" N 82°32'57.91" W elev 2200 ft eye alt 2385 ft



Site # 22

The North Carolina Arboretum

Frederick Law Olmsted Way



© 2013 Google

Google earth

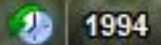

Imagery Date: 10/20/2010 35°30'04.22" N 82°35'57.98" W elev 2023 ft eye alt 2199 ft



Site # 23

N Market St

Thomas Wolfe Memorial 

© 2013 Google

Google earth

29 ft

1994

Imagery Date: 10/20/2010 35°35'50.77" N 82°33'04.71" W elev 2189 ft eye alt 2338 ft



Site # 24

~~BRP - Lost Cove/Brown Mtn. Lights~~

© 2013 Google

Google earth

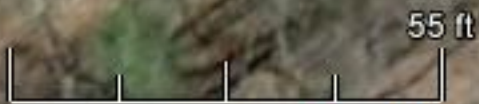

1995

Imagery Date: 4/2/2011 36°01'44.91" N 81°52'18.41" W elev 3808 ft eye alt 4042 ft



CUNNIA  
Mosses

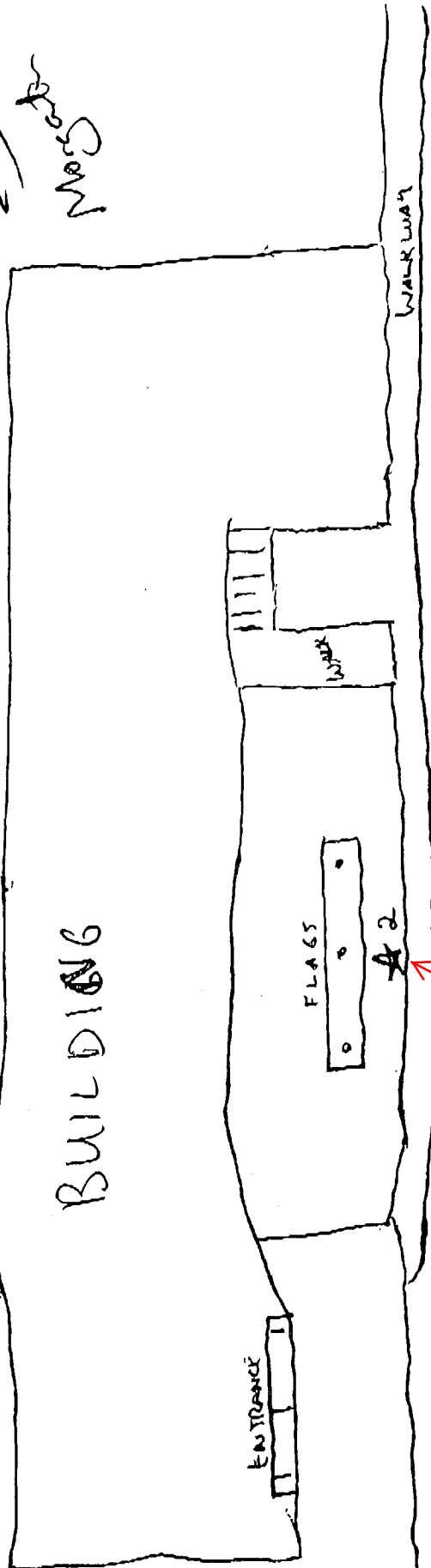

↑  
10  
12  
14

QUIETING

SITE 2 - AT FLAGS.

S COLLEGE ST.



Site # 26

 Revised Joara location

© 2015 Google

36 ft

1993

35°45'46.57" N 81°42'18.51" W



Site # 27



Linville Gorge - Brown Mountain Overlook

181

© 2013 Google

Google earth

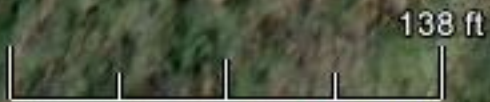

Imagery Date: 4/2/2011 35°56'30.18" N 81°50'31.25" W elev 2812 ft eye alt 3203 ft



Site # 28

# SOUTH MOUNTAINS STATE PARK VC

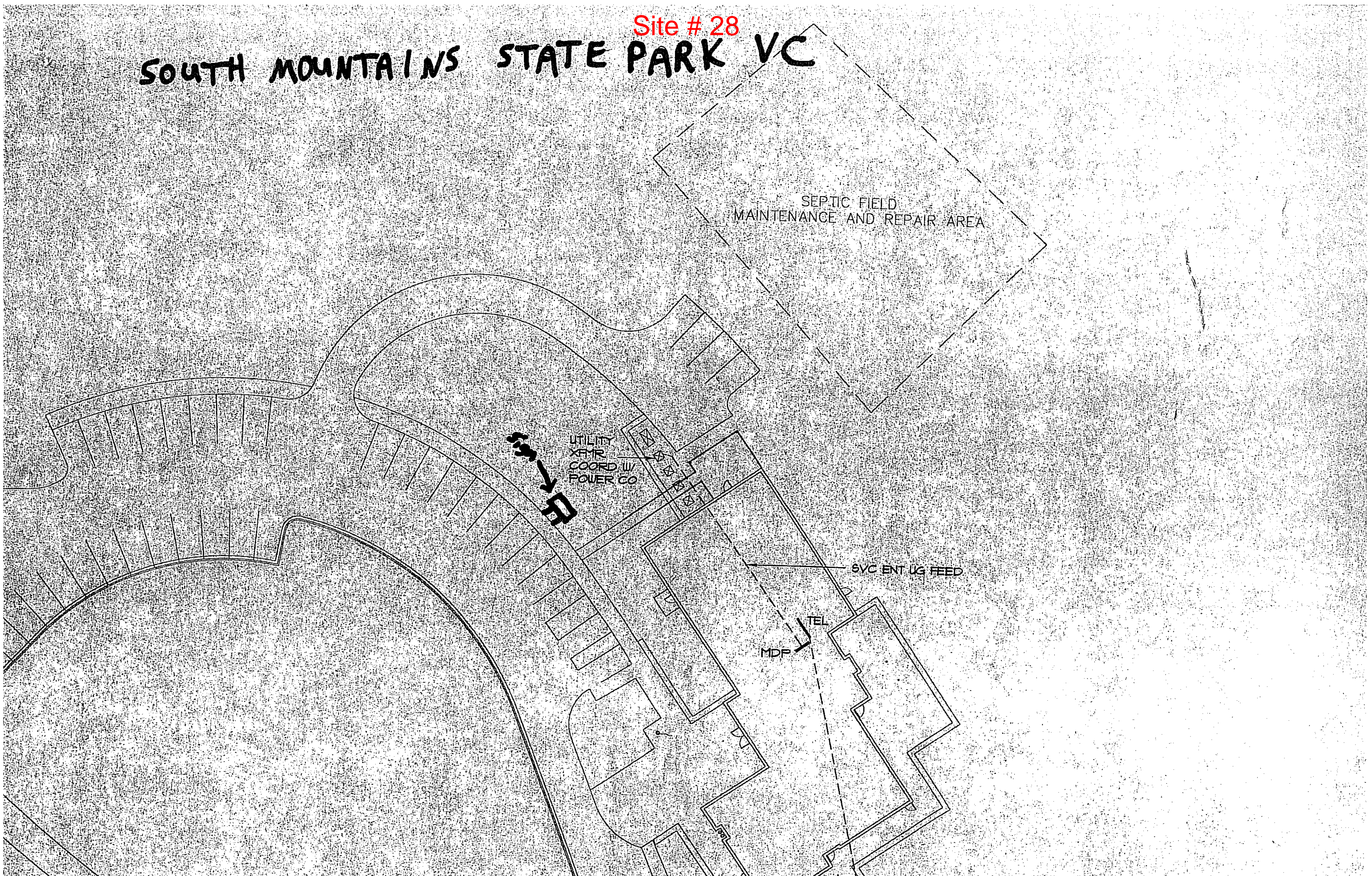







Site # 30

Hot Springs Welcome Center

S Spring St

45 ft

© 2013 Google

Google earth

1992

Imagery Date: 3/18/2013 35°53'33.24" N 82°49'39.47" W elev 1332 ft eye alt 1546 ft



Site # 31

I-26W Welcome Center Mars Hill Exhibit sign

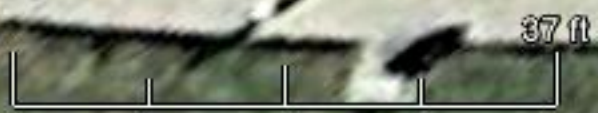

© 2013 Google

Image Landsat

Google earth

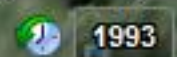

Imagery Date: 11/7/2013 35°52'26.98" N 82°32'40.32" W elev 2928 ft eye alt 3069 ft



# Site # 32

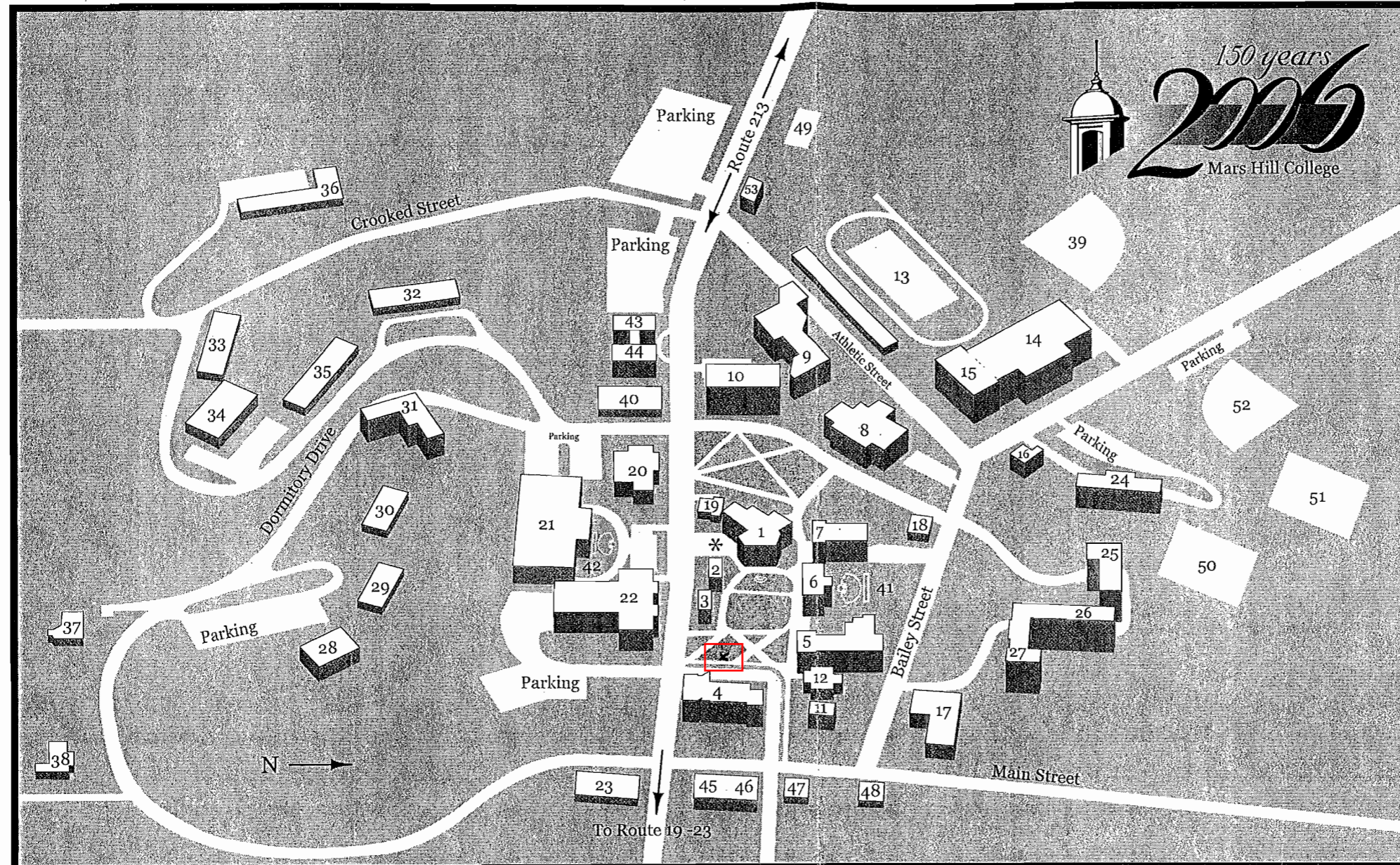

- 1 Blackwell Hall
- \*Visitor Parking
- 2 Founders Hall
- 3 Montague Hall
- 4 Cornwell Hall
- 5 Spilman Hall
- 6 Marshbanks Hall
- 7 McConnell Hall
- 8 Renfro Library
- 9 Wren College Union
- 10 Wall Science Building
- 11 Jarrett House (Campus Police)
- 12 Owen Theatre
- 13 Meares Stadium
- 14 Chambers Gym
- 15 Harrell Pool
- 16 Humphrey House
- 17 Mars Hill Baptist Church
- 18 Log Cabin
- 19 Robinson Infirmary
- 20 Memorial Hall
- 21 Pittman Dining Hall
- 22 Moore Auditorium
- 23 US Post Office
- 24 Fox Hall
- 25 Huffman Hall
- 26 Stroup Hall
- 27 Edna Moore Hall
- 28 Gibson Hall
- 29 Brown Hall
- 30 Turner Hall
- 31 Myers Hall
- 32 Dickson Palmer Unit B
- 33 Dickson Palmer Unit C
- 34 Town Houses
- 35 Dickson Palmer Unit A
- 36 Physical Plant
- 37 President's Home
- 38 Blackwell Residence
- 39 Henderson Field
- 40 Marleine Reader Harris Media Center
- 41 Anderson Amphitheater
- 42 Ellen Amphitheater
- 43 Broyhill Chapel/English Garden
- 44 Bentley Fellowship Hall & Memorial Garden
- 45 MHC Bookstore
- 46 Paw Prints Copy Center
- 47 Mars Hill Town Hall
- 48 Mars Hill Fire Department
- 49 Hart Tennis Complex
- 50 Practice Field
- 51 Ponder Field
- 52 Softball Field
- 53 Phillips House

# Campus Map

Mars Hill College

\* Blue Ridge National Heritage Area marker will be placed next to sidewalk north of campus quad entrance near Rural Life Museum & Madison County Visitor Center.



Site # 33

N

~~The Loops~~

Blue Ridge Pkwy

Orchard Rd

94 ft

© 2013 Google  
Image Landsat

Google earth



1997

Imagery Date: 4/9/2013 35°52'27.97" N 82°01'32.65" W elev 2980 ft eye alt 3450 ft



# Site # 34

Mt. Mitchell

Hwy 80



Tom Johnson Center  
Camping Center

old fort

west



Buck Creek

GRAVEL  
DRIVE

GRAVEL  
DRIVE

+

Carson  
House

Hwy 70

East

main





Linnville Caverns  
parking area

Drawing # 1

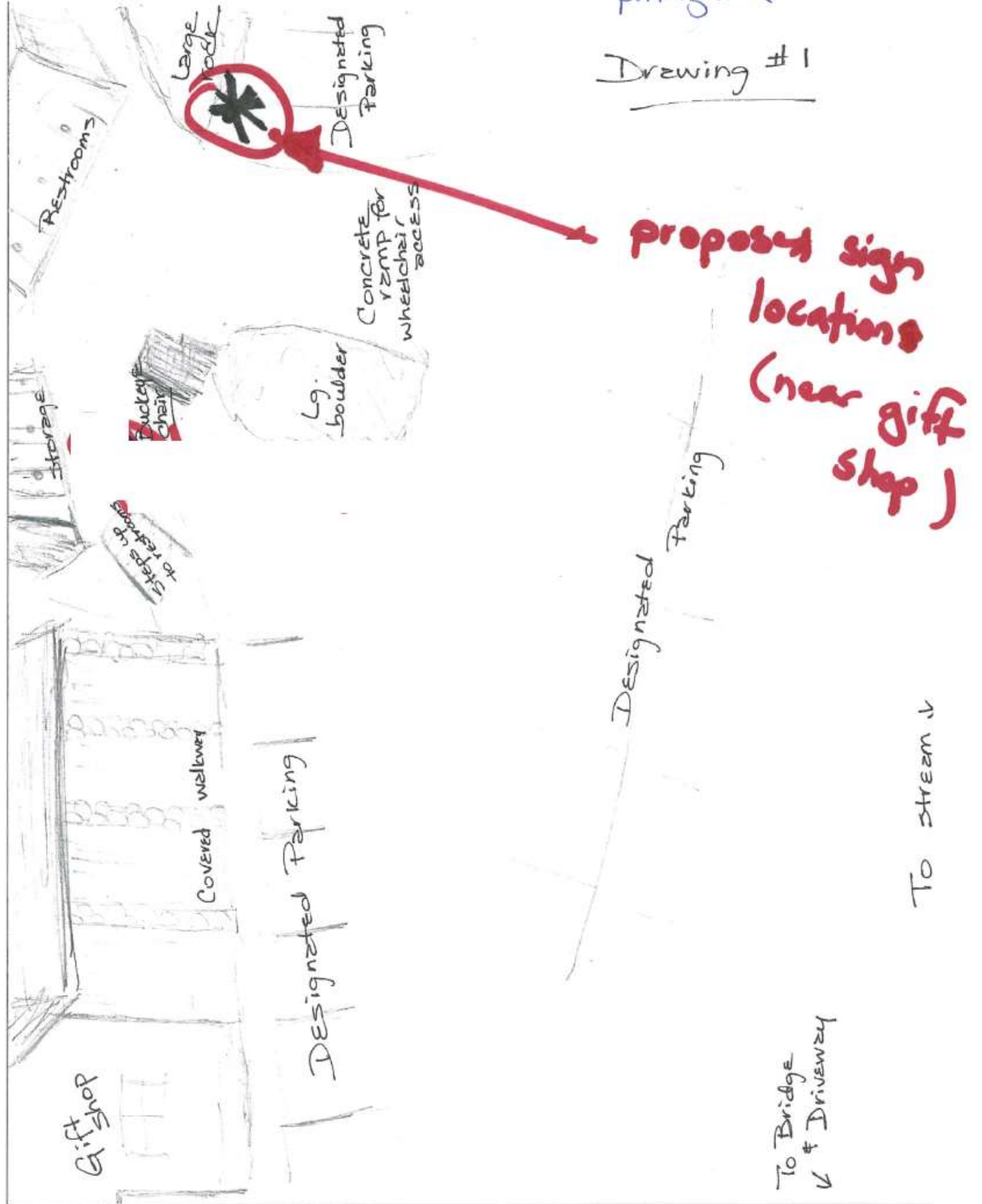



Site # 36

Mountain Gateway Museum

Water St

33 ft

© 2013 Google

Google earth

1993

Imagery Date: 10/20/2010 35°37'39.22" N 82°10'48.25" W elev 1426 ft eye alt 1592 ft